

BATTERIA SIGILLATA AGM CON ELEVATO SPUNTO DI AVVIAMENTO  
AGM MAINTENANCE FREE BATTERY WITH HIGH CRANKING RATE

# ZPC120030



## CHARACTERISTIC / CARATTERISTICHE

Volt	12V	
Capacity / Capacità	20h	30 Ah
Reserve capacity at 25A/ Riserva di capacità a 25A	60 min.	
Positive / Positivo	dx	
Short circuit current / corrente costo circuito	1.550Amp	
EN Cranking features / Prestazioni avviamento EN	PHCA 5scc. 27°C	950Amp
	CCA	450Amp
	CA	550Amp
	HCA 27°C	635Amp
Self-Discharge 25°C Capacity / Autoscarica a 25°C	after 3 month storage	90%
	after 6 month storage	80%
	after 12 month storage	62%
Charge (constant voltage) 25°C	Float	13.6 - 13.8 Volt
	Charge	Max. 9.0Amp. 14.4 - 14.8 Volt

## CHARACTERISTIC / CARATTERISTICHE

Battery dimensions / Dimensioni batteria			
L/L	W/P	H/A	Tot - H/A
250	97	142	156
Weight / Peso			10 Kg
Terminal / Terminali			M6
Plt Qt / Qt per pallet			75
Case / Contenitore			ABS

## HIGH RATE DISCHARGE "EN" CORRENTE DI SPUNTO, "EN" (25°C)

5 sec.	10 sec.	15 sec.	20 sec.
950A	850A	720A	635A

## EXTENDED DISCHARGE (25°C) TO 10.02V CORRENTE DI SCARICA FINO A 10.2VOLT (25°C)

5 min	15 min	1 hr	3 hr	5 hr	10 hr	20 hr
134A	61A	20A	7.8A	5A	2.7A	1.5A

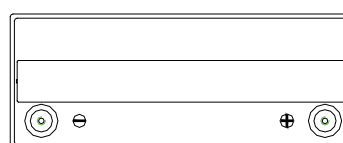
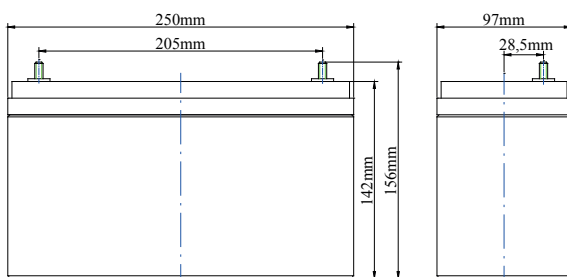

Terminal: M6M

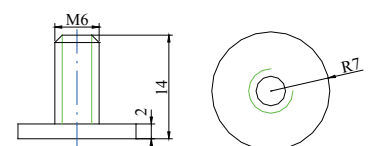

This information is generally descriptive only and is not intended to make or imply any representation, guarantee or warranty with respect to any cells and batteries. Cell and battery designs/specifications are subject to modification without notice. Contact U.B.S. UNION BATTERY SERVICE for the latest information.

Le informazioni contenute in questa scheda tecnica sono solo descrittive e indicative, non sono una garanzia. U.B.S. UNION BATTERY SERVICE si riserva il diritto di aggiornarle/modificarle senza preavviso.



[www.unionbatteryservice.it](http://www.unionbatteryservice.it)